

Dated.....*8th August*.....2024

**THE CITY OF BRADFORD METROPOLITAN DISTRICT COUNCIL
(TOLLER LANE AND WHETLEY HILL, BRADFORD)
(HIGHWAY JUNCTION IMPROVEMENT SCHEME)
COMPULSORY PURCHASE ORDER 2021**

GENERAL VESTING DECLARATION

-made and executed by-

The City of Bradford Metropolitan District Council

-pursuant to-

The Compulsory Purchase (Vesting Declarations) Act 1981

-in respect of -

**Freehold estate comprising 51 square metres of land situate to the east off Toller Lane,
near to its junction with Carlisle Road, Bradford.**

**Jason Field
Director of Legal and Governance
Department of Corporate Resources,
The City of Bradford Metropolitan District Council,
City Hall, Centenary Square, Bradford
West Yorkshire BD1 1HY**

This **GENERAL VESTING DECLARATION** is executed on the 8th day of August 2024

by The City of Bradford Metropolitan District Council ("**the Authority**")

WHEREAS

On 16th July 2021 an order entitled The City of Bradford Metropolitan District Council (Toller Lane and Whetley Hill, Bradford) (Highway Junction Improvement Scheme) Compulsory Purchase Order 2021 was confirmed by the Secretary of State for Transport under the powers conferred on him by the Highways Act 1980 authorising the Authority to acquire the land specified in the Schedule hereto.

Notice of confirmation of the order was first published in accordance with section 15 of the Acquisition of Land Act 1981 on 19th August 2021.

That notice included the statement and form prescribed under section 15(4) (e) and (f) of the Acquisition of Land Act 1981.

NOW THIS DEED WITNESSETH that, in exercise of the powers conferred on them by section 4 of the Compulsory Purchase (Vesting Declarations) Act 1981 ("**the Act**"), the Authority hereby declare the land described in the Schedule hereto being part of the land authorised to be acquired by the order and more particularly delineated on the plan annexed hereto, together with the right to enter and take possession of the land shall vest in the Authority as from the end of the period of three months from the date on which the service of notices required by section 6 of the Act is completed.

SCHEDULE

ALL THAT freehold estate comprising 51 square metres of land situate to the east off Toller Lane near to its junction with Carlisle Road, Bradford, as shown more particularly delineated and edged red on the plan annexed hereto, being part of the land registered at HM Land Registry under Title number WYK710795.

EXECUTED as a **DEED** by affixing
the **COMMON SEAL** of
The City of Bradford Metropolitan District Council
in the presence of



Authorised Signatory



103520B

Dated 8th August 2024

MS 1

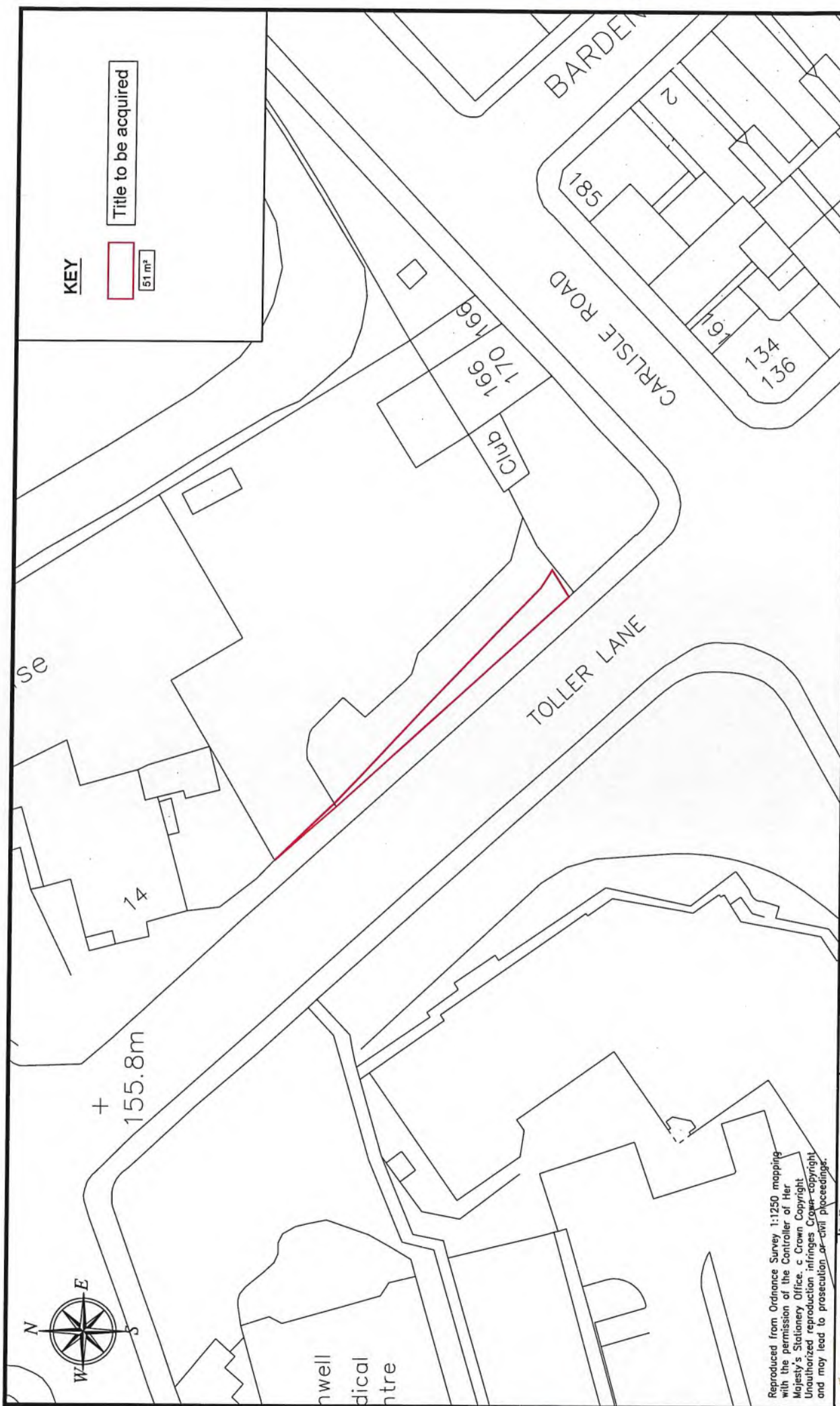

KEY

Title to be acquired
 51 m²

BRADFORD <small>METROPOLITAN DISTRICT COUNCIL</small> Department of Place Strategic Director: David Shephard		Project TOLLER LANE / WHETLEY LANE HIGHWAY SCHEME		Drawing Title SCHEME 3 : PLOT No.15 Landscaping east of highway on Toller Lane	
<small>Drawn by</small> Highway Services Bilnwick House Hall Ings Bradford BD1 1YD		Design RJK Scale 0 to 1:500 Engineer in Charge Richard Gelder B.Eng (Hons) L.Eng MICE		Checked AM Approved CB	
Client Toller Lane / Whetley Lane Highway Scheme		Drawn RJK Date MAY 2024		Released RJK Date MAY 2024	
Revision A Original		Initials RJK		Date 01.05.24	

Reproduced from Ordnance Survey 1:1250 mapping
 with the permission of the Controller of Her
 Majesty's Stationery Office. © Crown Copyright
 Unauthorized reproduction infringes Crown Copyright
 and may lead to prosecution or civil proceedings.

